

DESIGN E MODELAGEM 3D COMO OTIMIZADORES DA REALIZAÇÃO PROJETUAL

Universidade Federal do Rio de Janeiro

Centro de Letras e Artes

Escola de Belas Artes

XXXVIII Jornada Giulio Massarani de Iniciação Científica

Autor: Vitor Bruno Santos da Costa

Coautores: Lara de Oliveira e Thaís Guerra

Orientadores: Guto Nóbrega e Malu Fragoso

Núcleo de Arte e Novos Organismos – NANO



Estruturas personalizadas: garantir a realização fiel do conceito projetual;

Prototipagem rápida: adequar-se ao método de fabricação;

Organização: facilitar o acesso aos arquivos;

Hierarquização da montagem: facilitar a compreensão e edição das peças;

Comunicação: estabelecer o elo entre a modelagem e a fabricação;

Problemas e Objetivos



Software

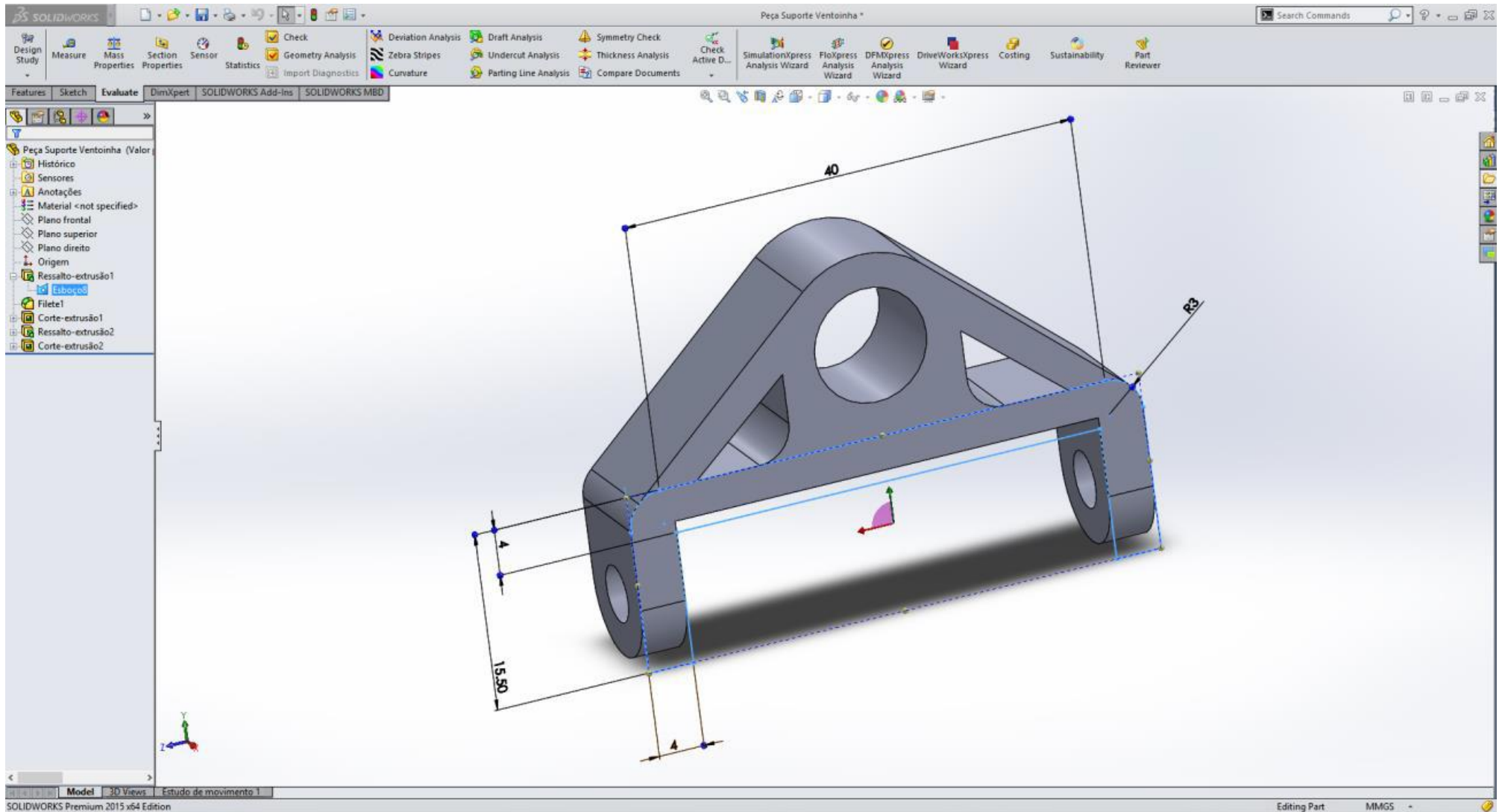

Software

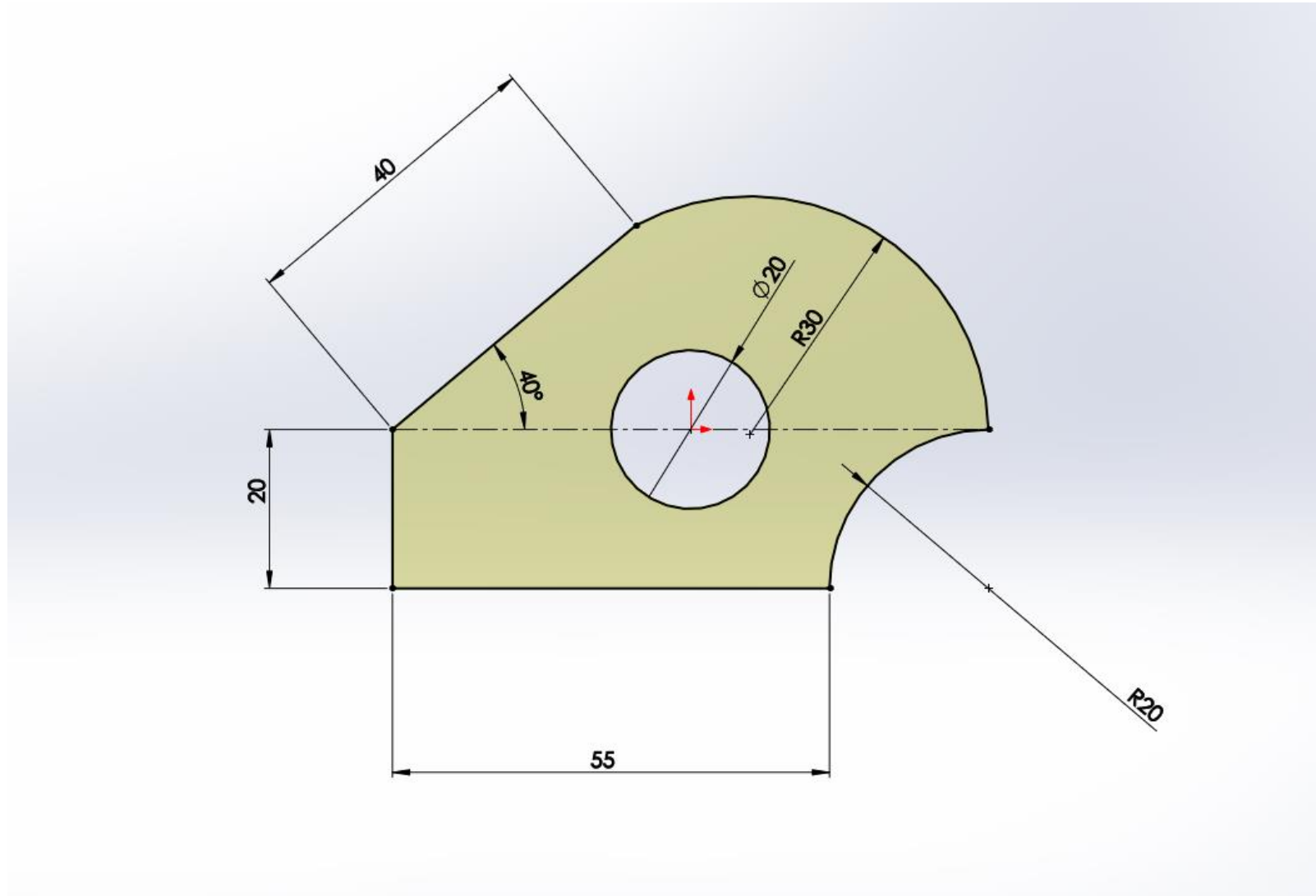

Software

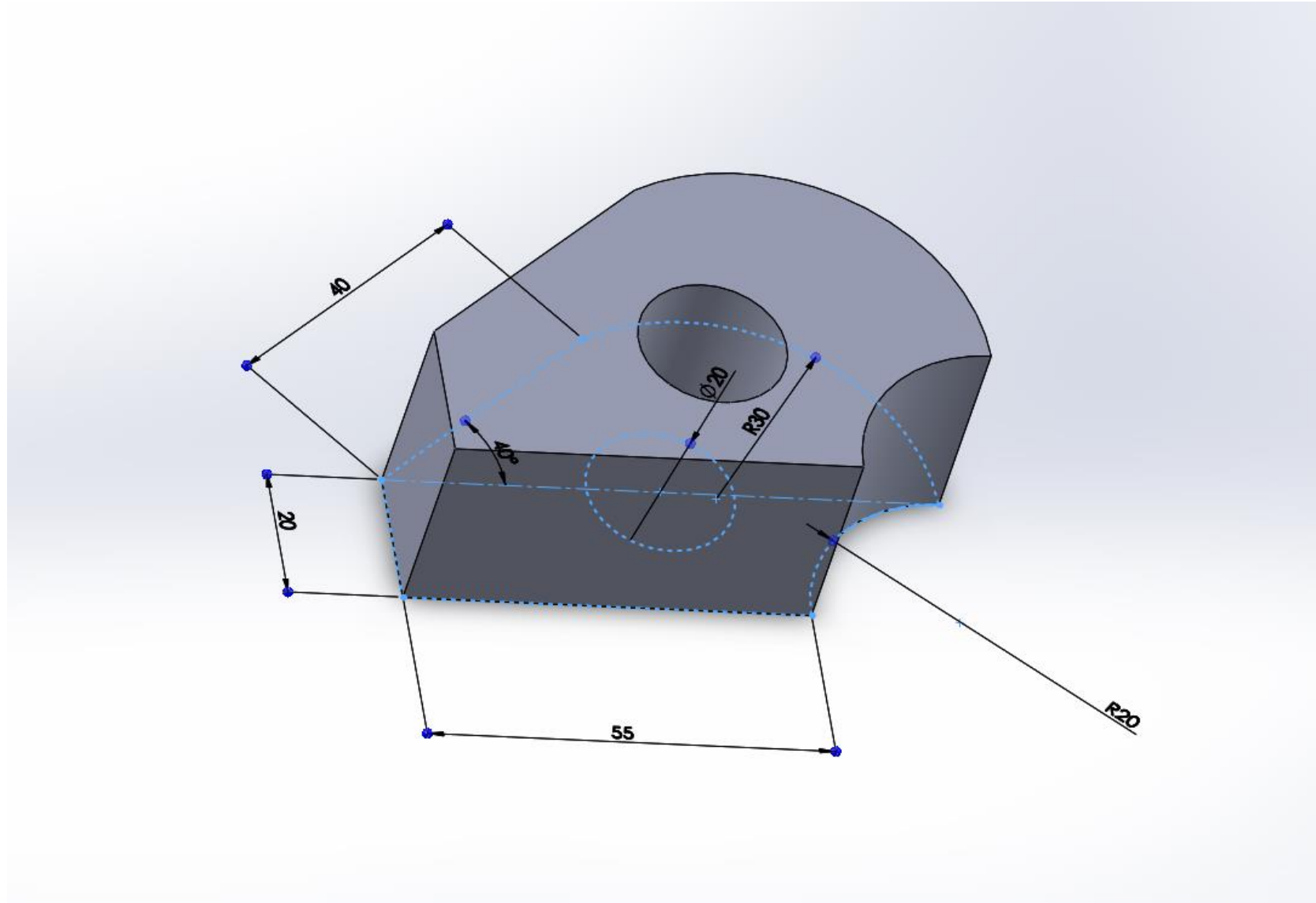

Software

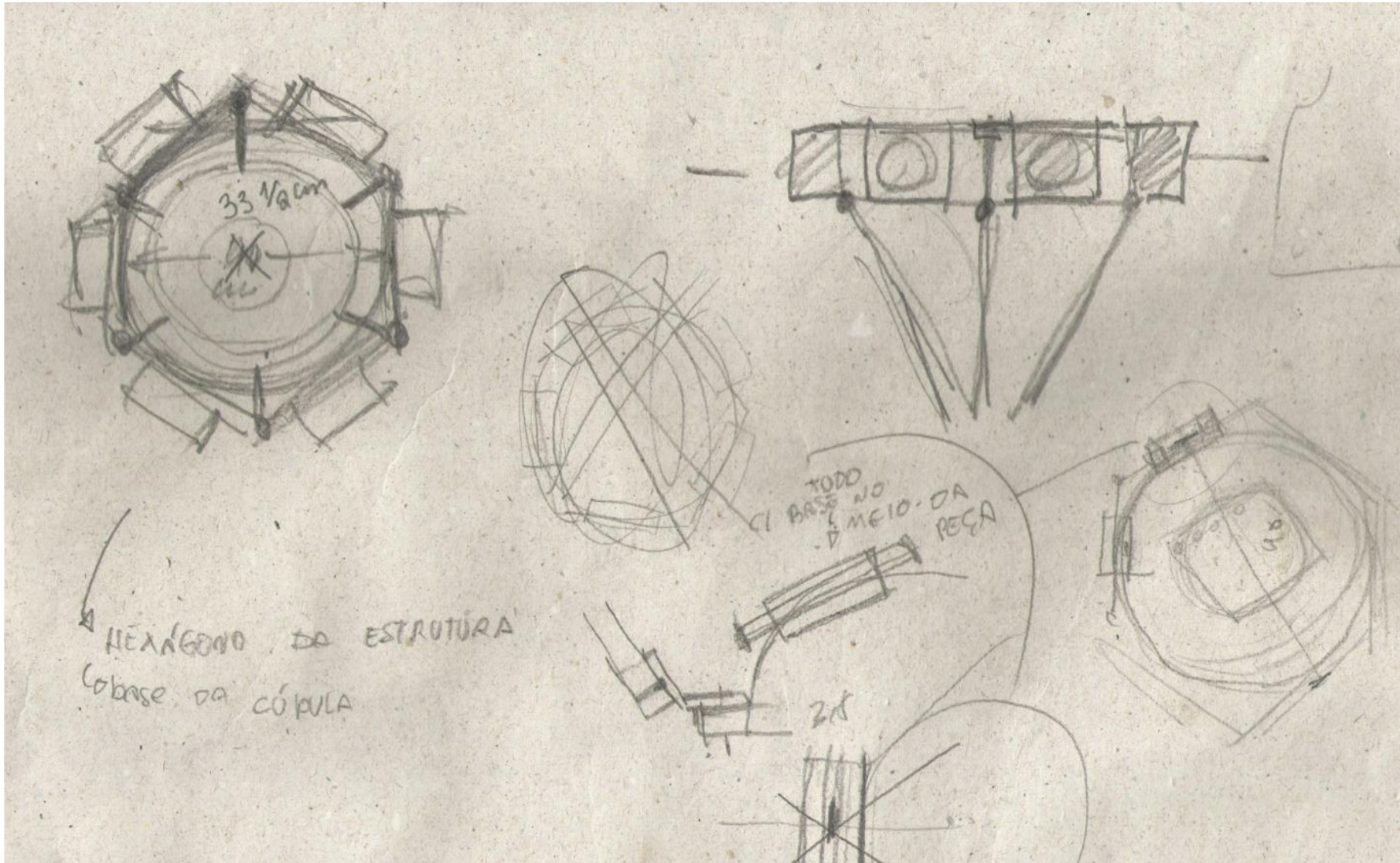

Workflow: Discussão do objetivo inicial

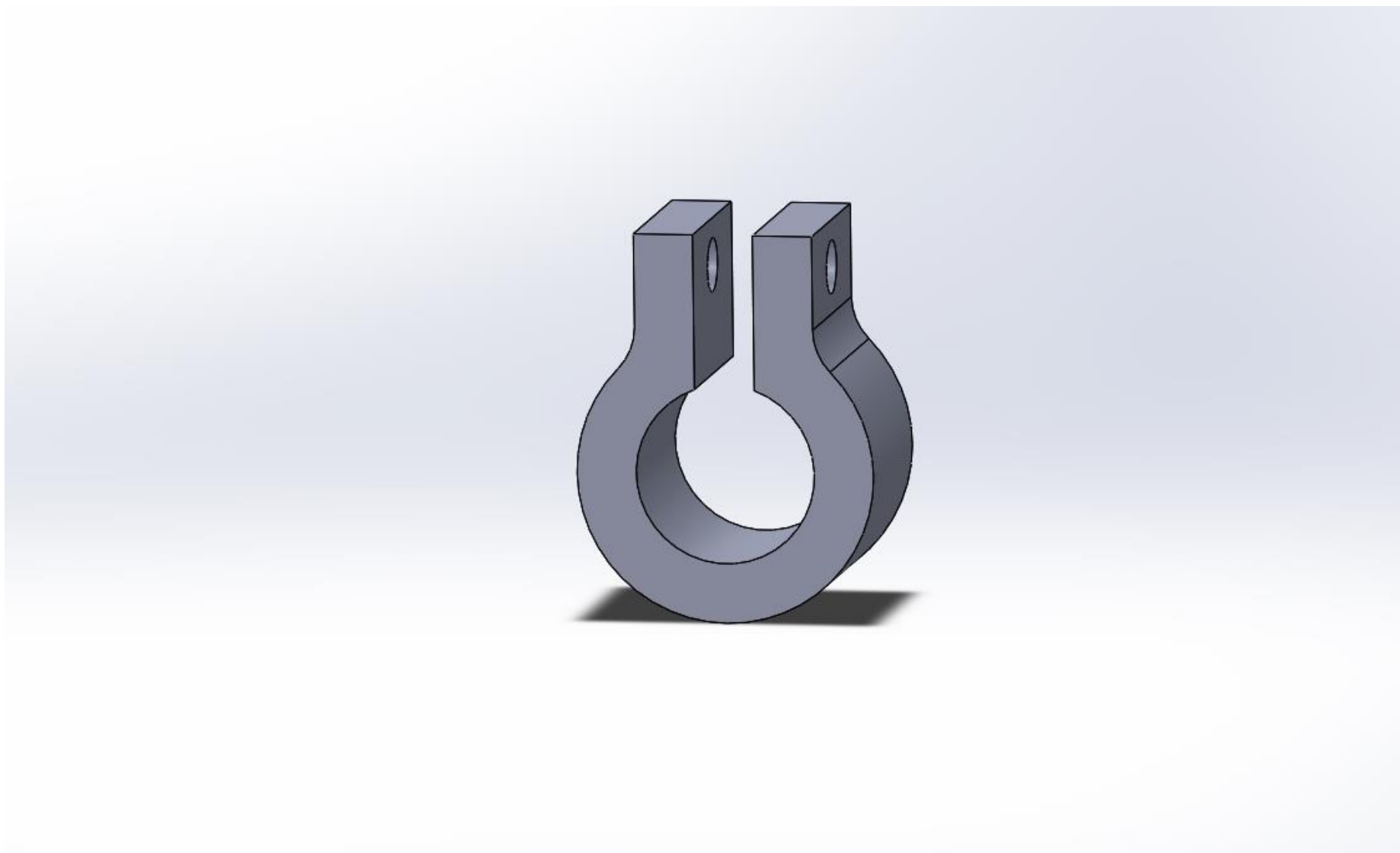

Workflow: Criação de um modelo primitivo



Workflow: Fabricação inicial para testes práticos

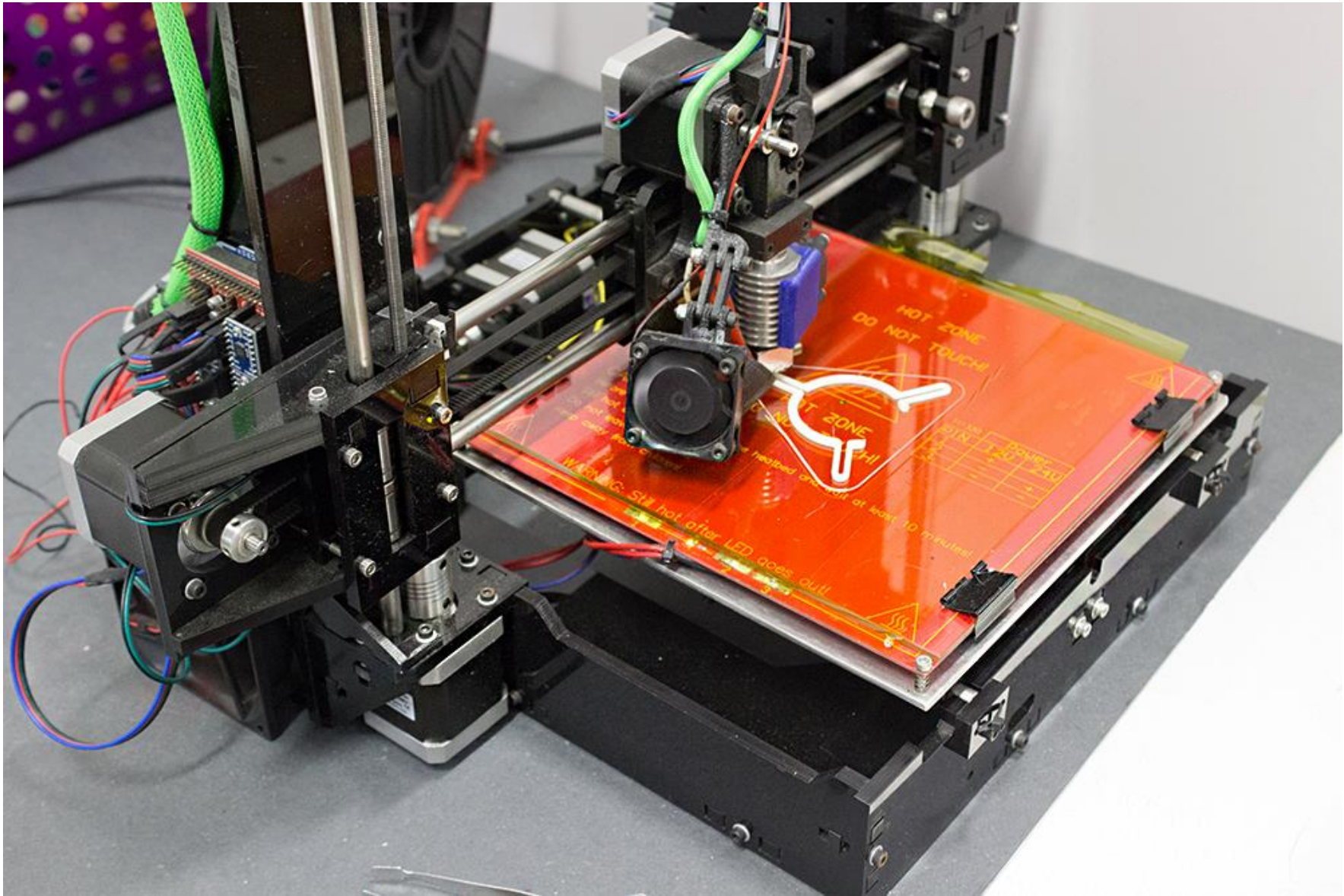

Workflow: Adequação às condições de fabricação

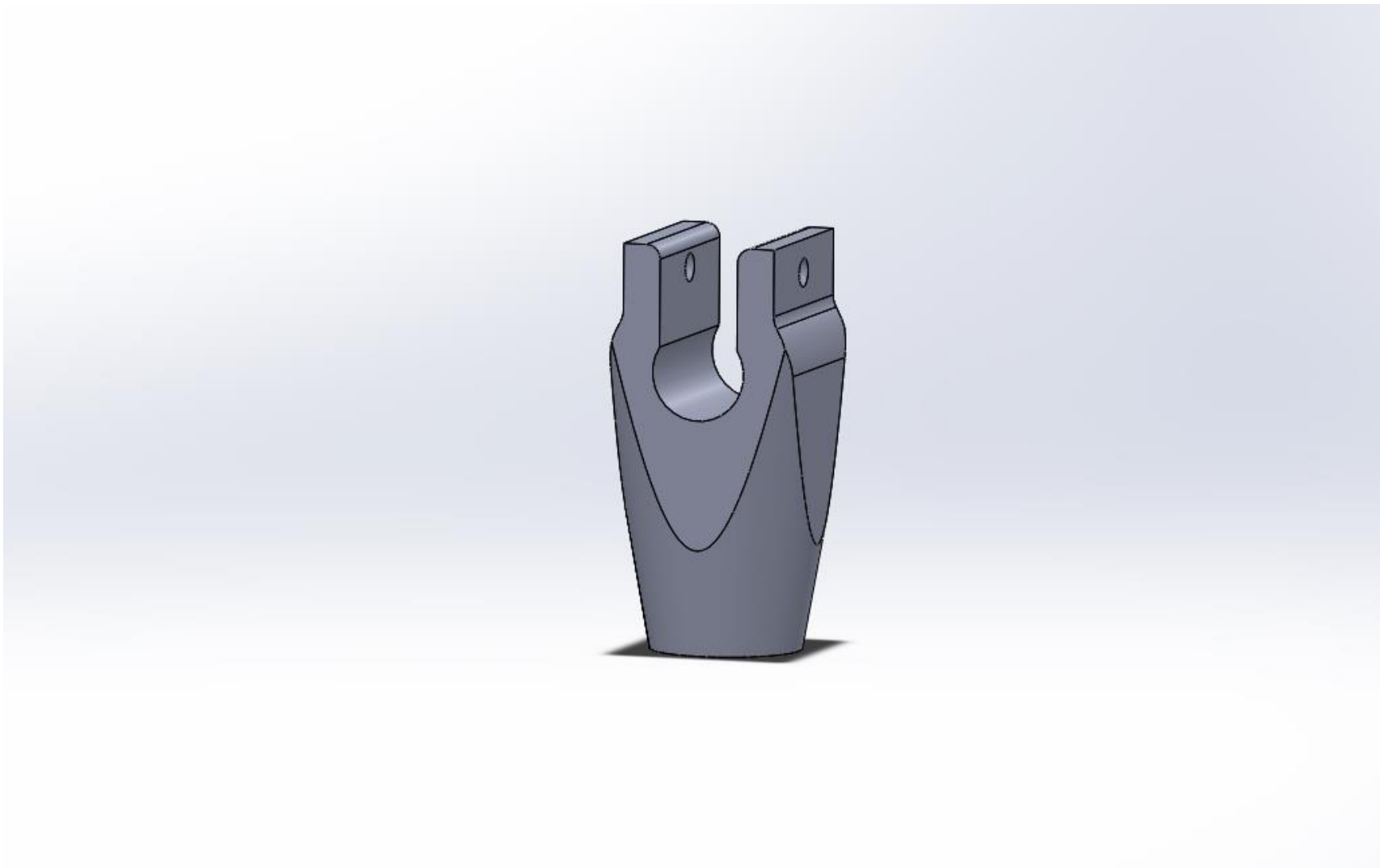

Workflow: Retorno e refinamento

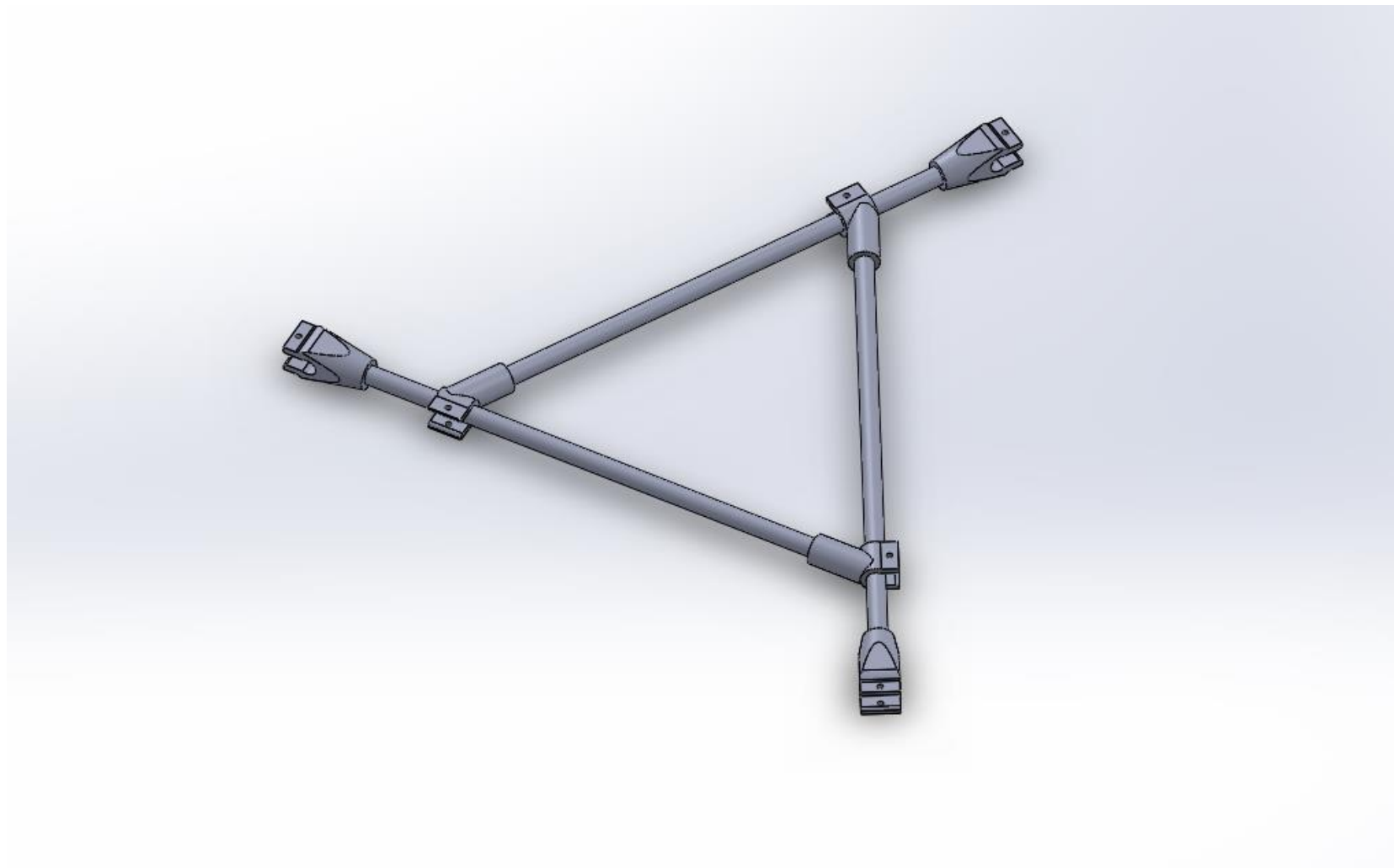

Workflow: Teste virtual no escopo da montagem

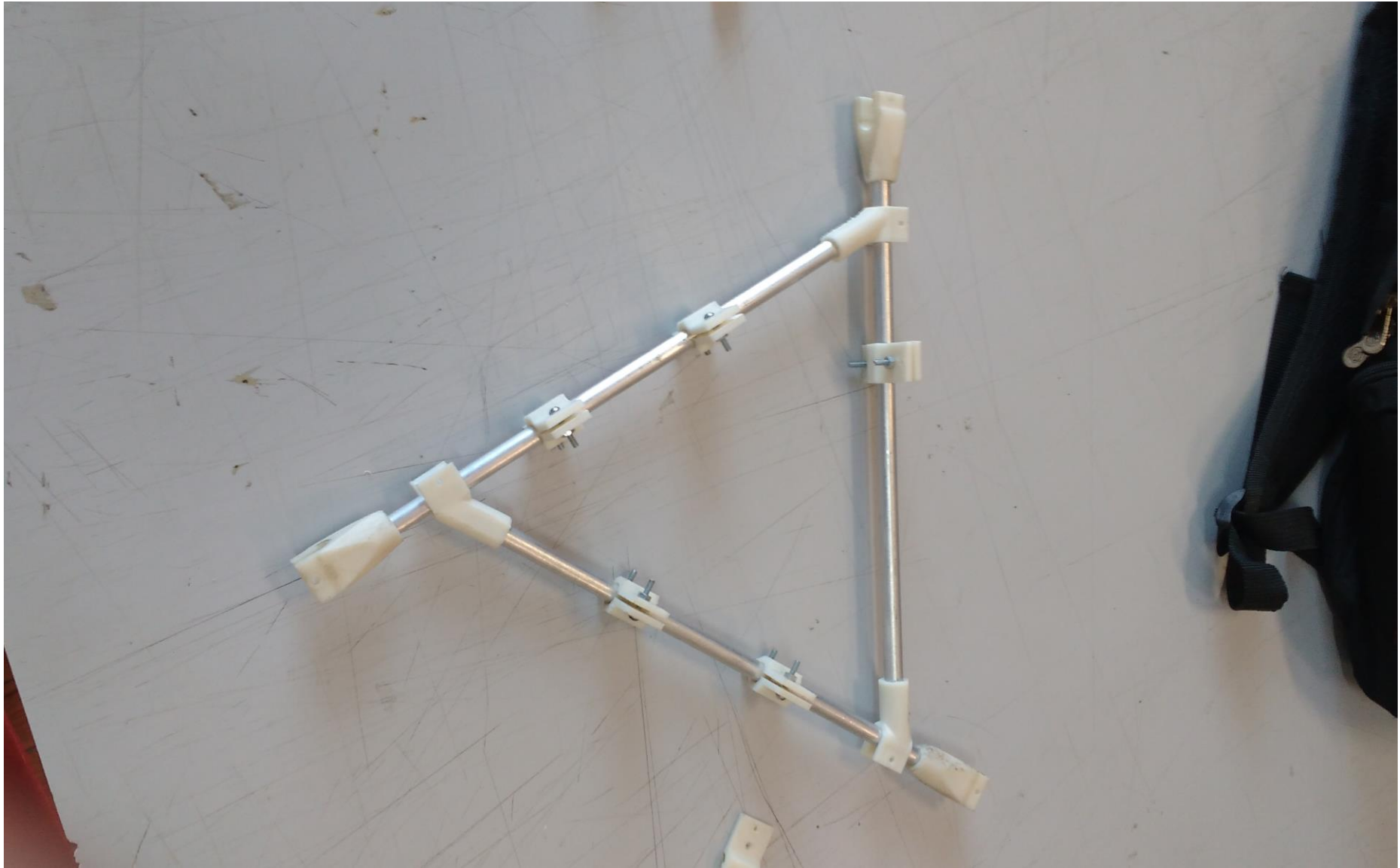



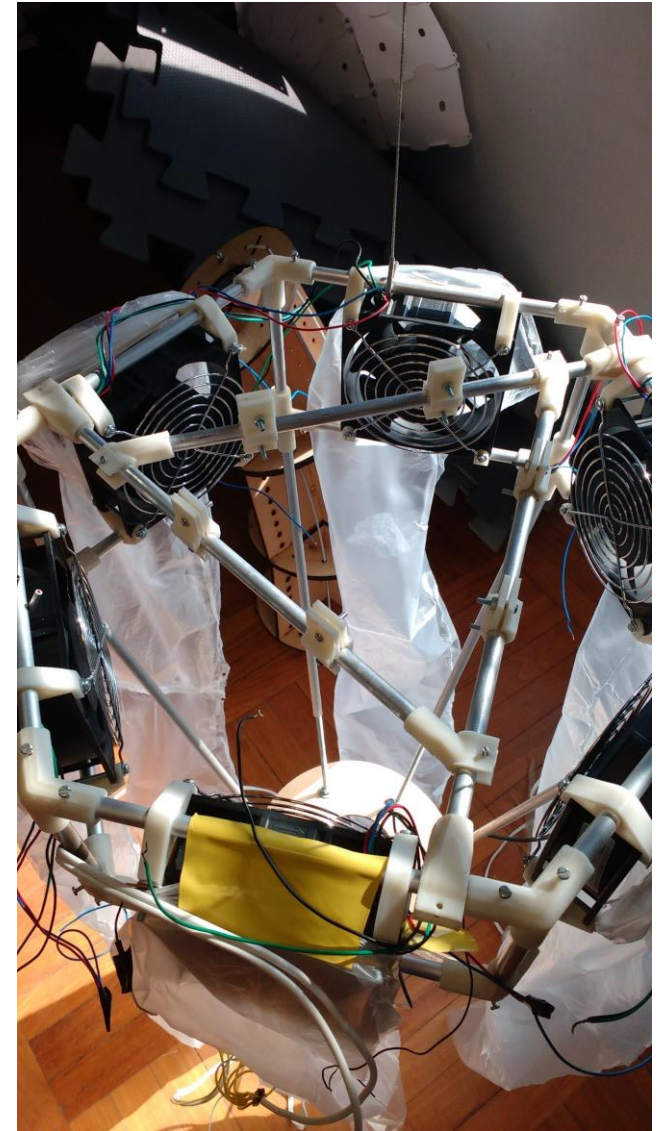
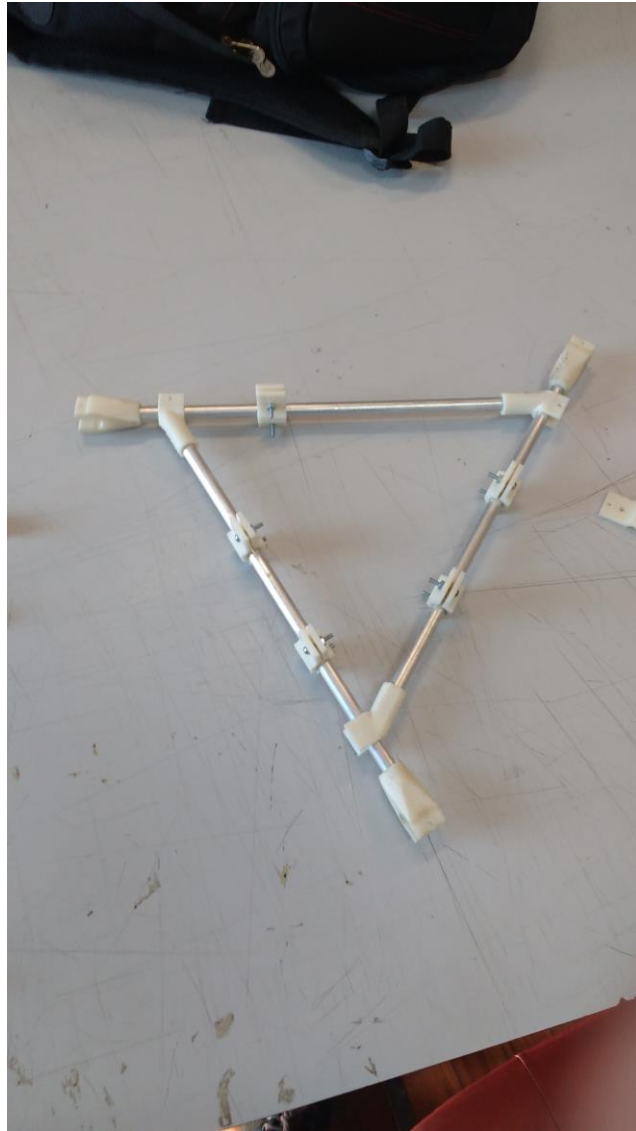









Workflow: Peça final



Workflow: Instalação da peça

> Modelagem > Modelagem > Hexa

 Encaixe quadruplo Type: SOLIDWORKS Part Document	Date modified: 5/11/2016 8:24 PM Size: 107 KB
 Encaixe triplo Type: SOLIDWORKS Part Document	Date modified: 5/11/2016 8:24 PM Size: 94.6 KB
 Garra com Entrada versao chique Type: SOLIDWORKS Part Document	Date modified: 5/11/2016 8:24 PM Size: 125 KB
 Montagem completa Type: SOLIDWORKS Assembly Document	Date modified: 5/11/2016 8:24 PM Size: 213 KB
 Peça Suporte Ventoinha Type: SOLIDWORKS Part Document	Date modified: 5/11/2016 8:24 PM Size: 117 KB
 Submontagem Ventoinha Única Type: SOLIDWORKS Assembly Document	Date modified: 5/11/2016 8:24 PM Size: 129 KB
 Triangulador Type: SOLIDWORKS Part Document	Date modified: 5/11/2016 8:24 PM Size: 105 KB
 Tubo Aumentado Type: SOLIDWORKS Part Document	Date modified: 5/11/2016 8:24 PM Size: 53.1 KB
 Tubo Diagonal Type: SOLIDWORKS Part Document	Date modified: 5/11/2016 8:24 PM Size: 29.4 KB
 Tubo Triangulo Type: SOLIDWORKS Part Document	Date modified: 5/11/2016 8:24 PM Size: 49.7 KB
 Tubo vertical curto Type: SOLIDWORKS Part Document	Date modified: 5/11/2016 8:24 PM Size: 60.8 KB
 Ventoinha Type: SOLIDWORKS Part Document	Date modified: 5/11/2016 8:24 PM Size: 99.2 KB

Workflow: Divisão e organização da montagem

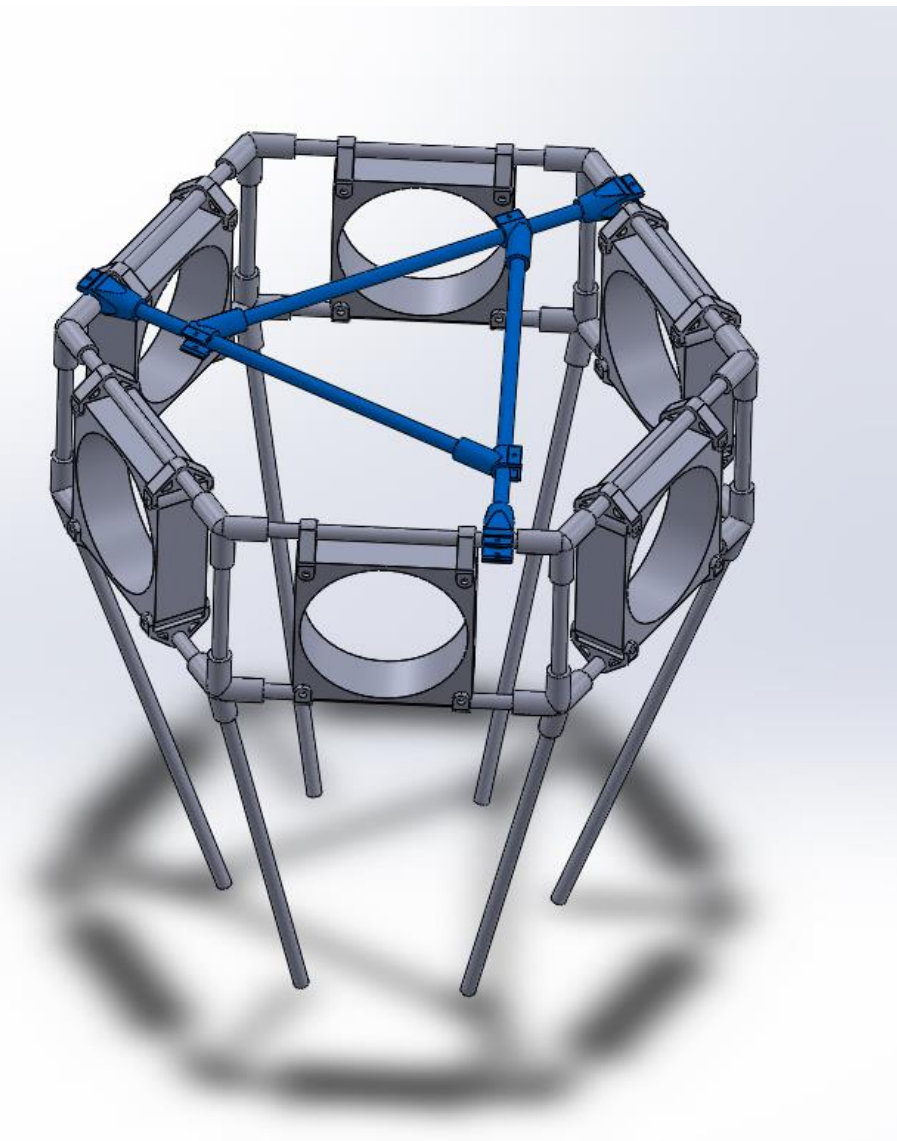
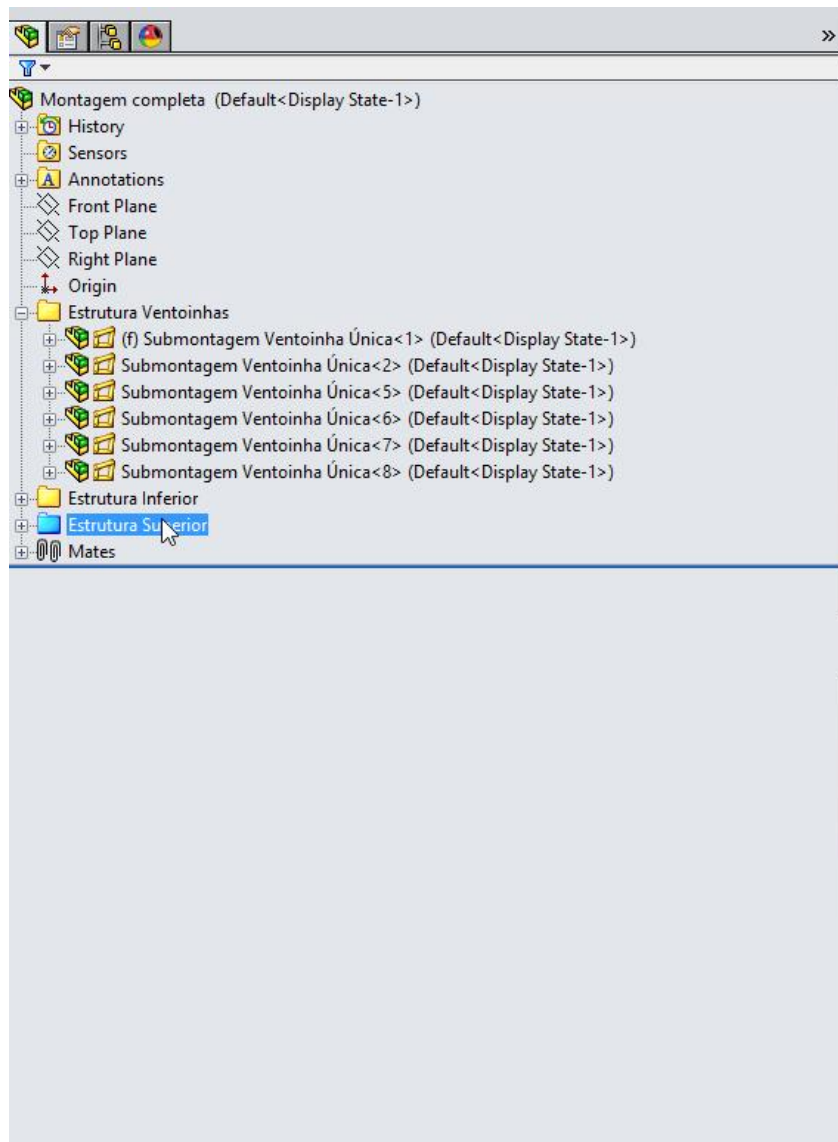

Workflow: Divisão e organização da montagem

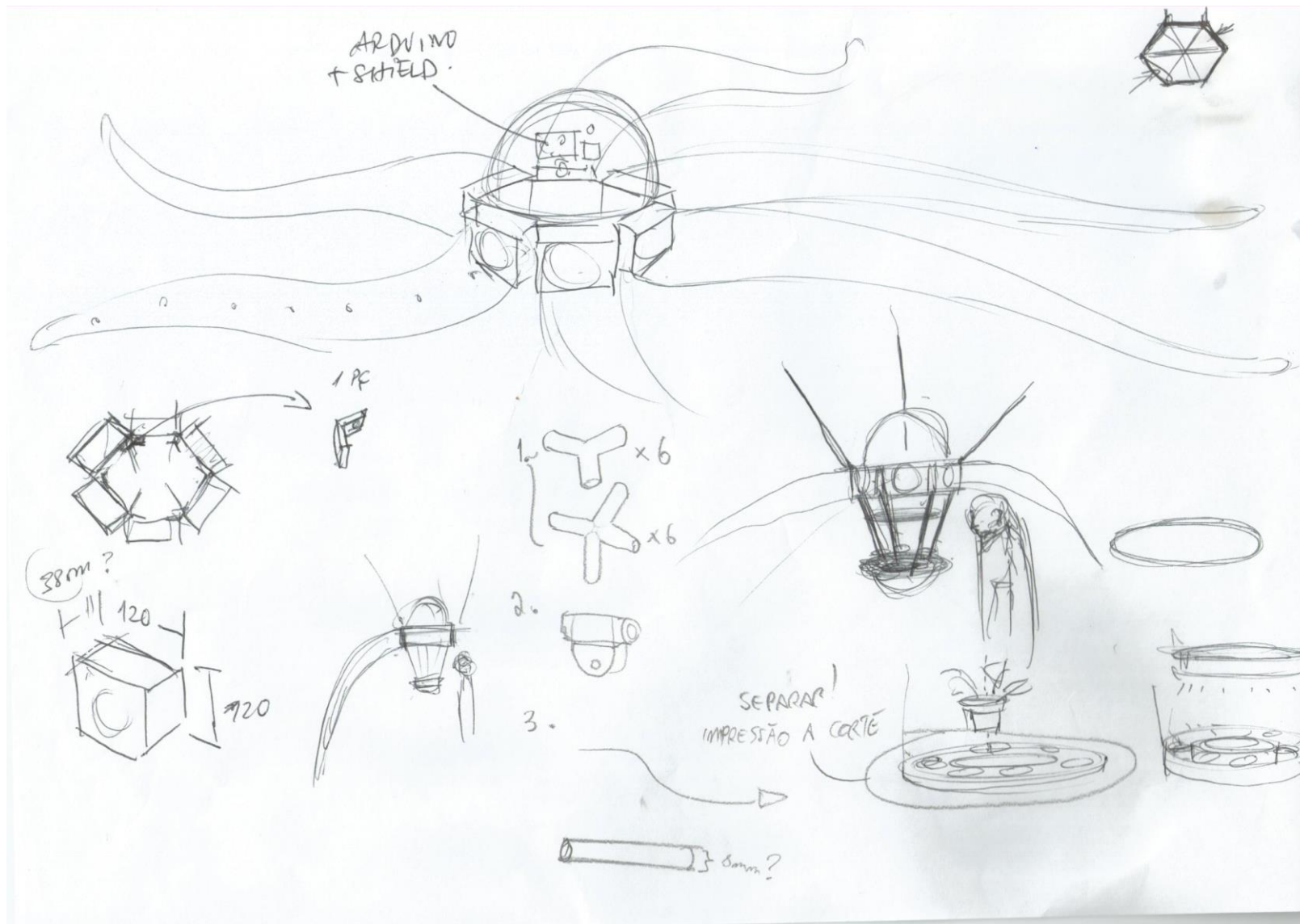

Projetos: Hexa/Polvo

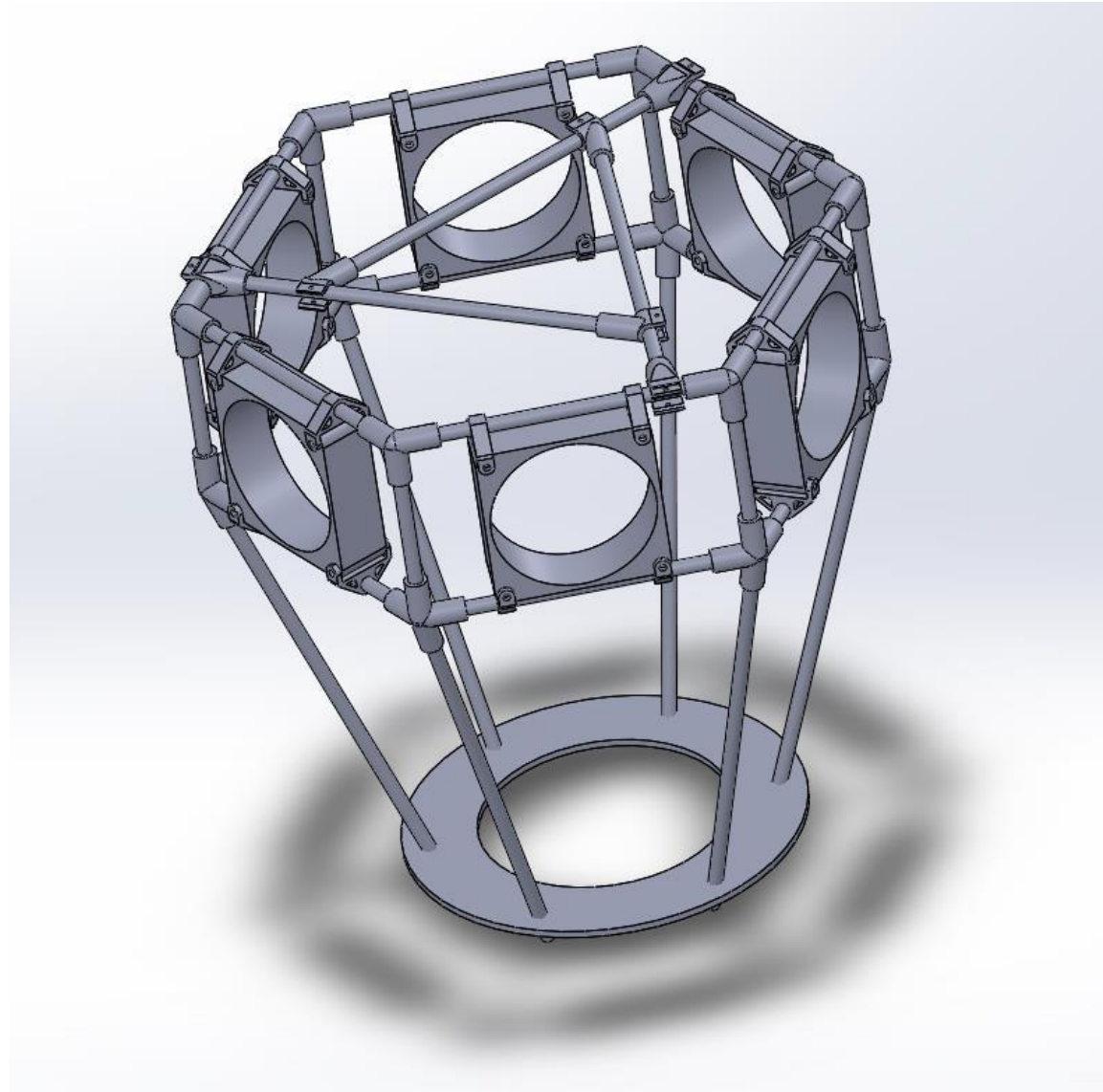

Projetos: Hexa/Polvo

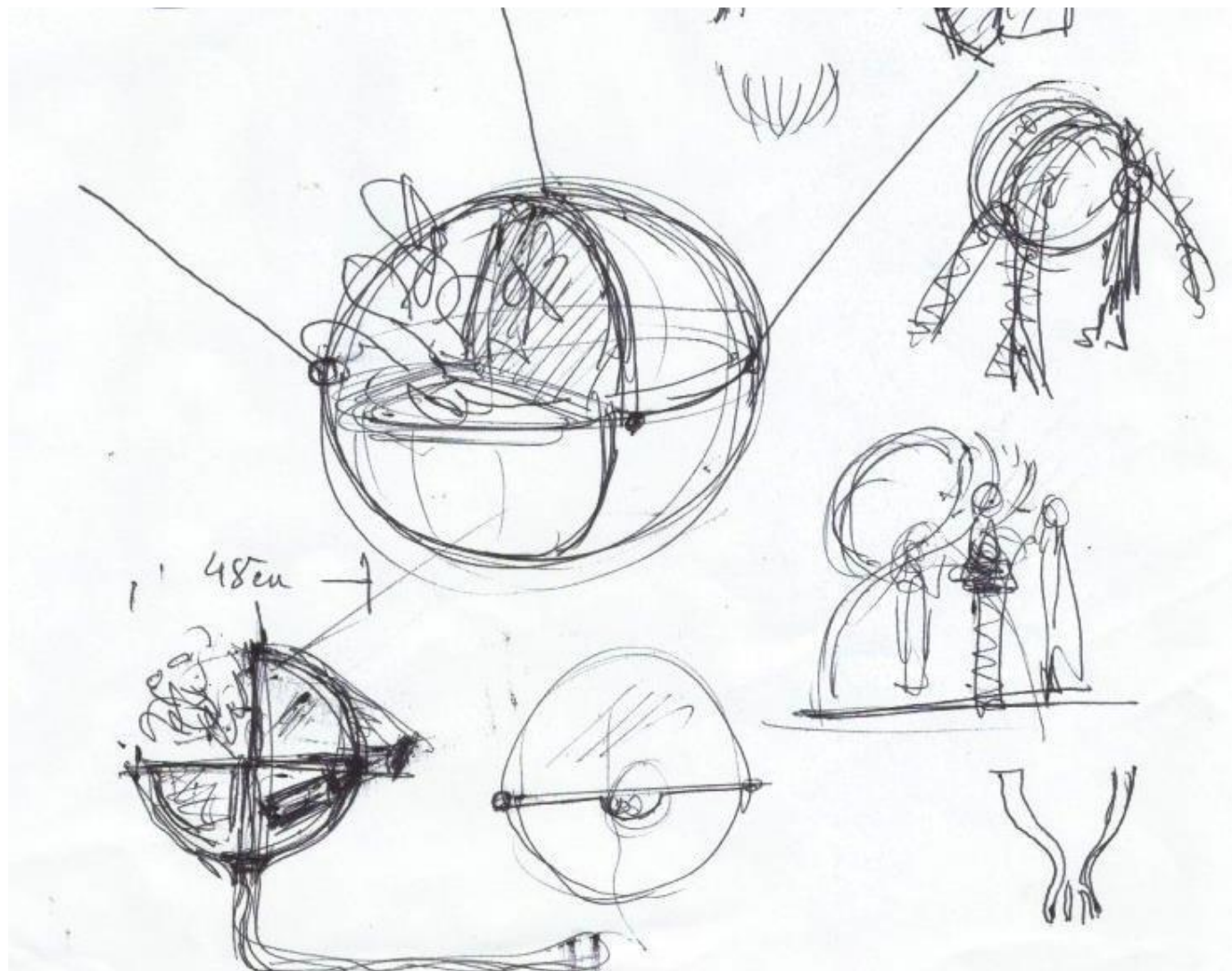

Projetos: Telebiosfera

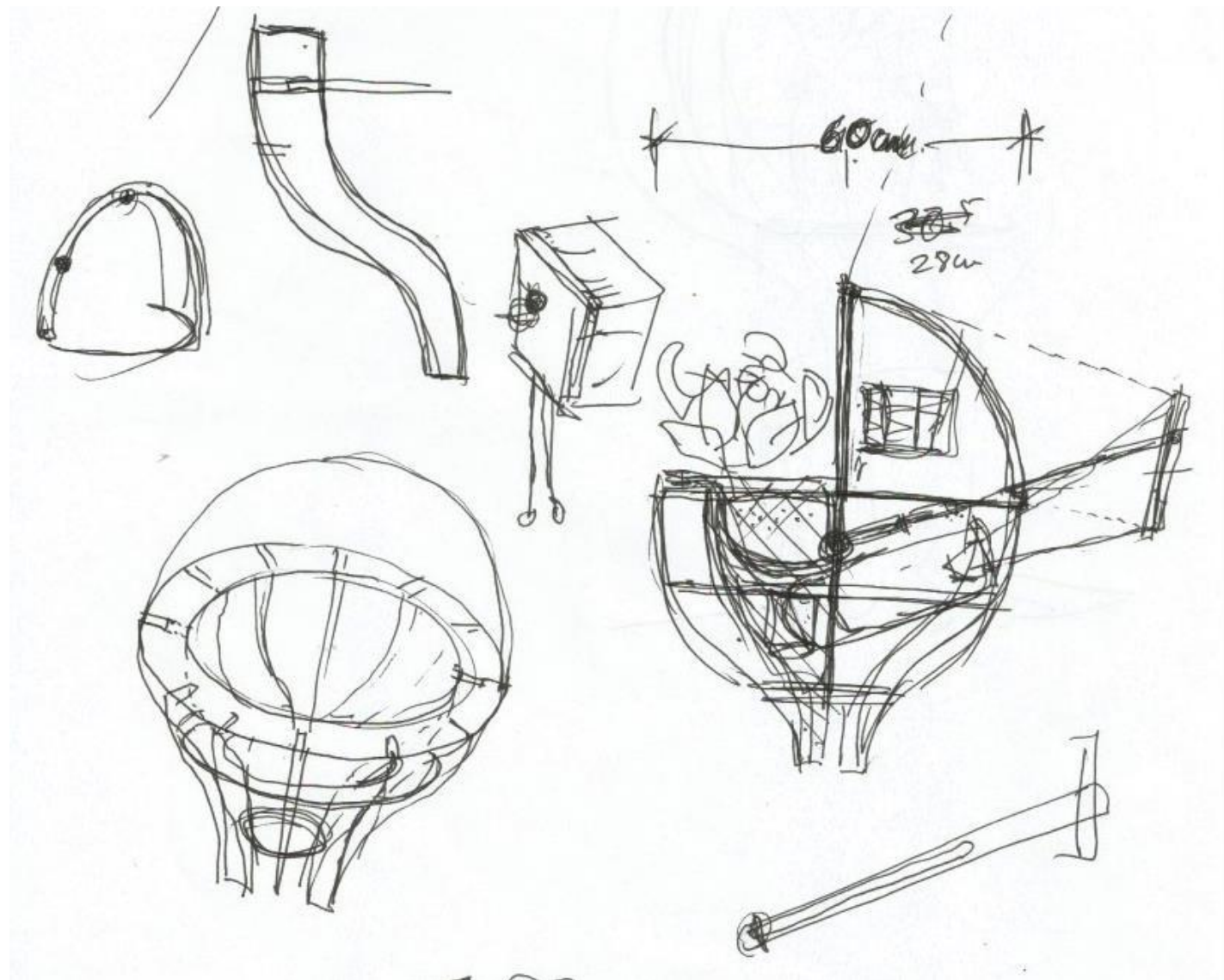

Projetos: Telebiosfera

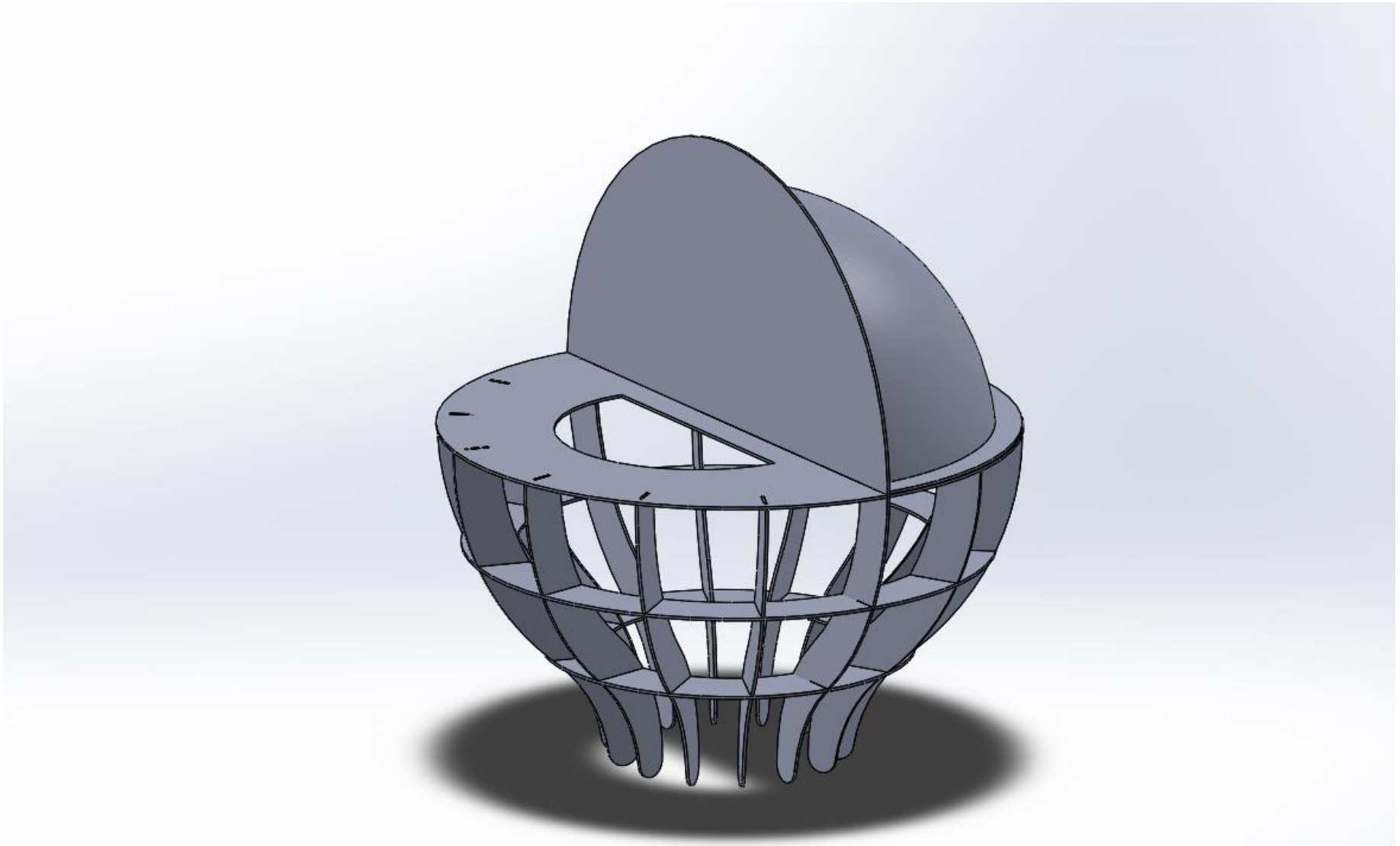

Projetos: Telebiosfera

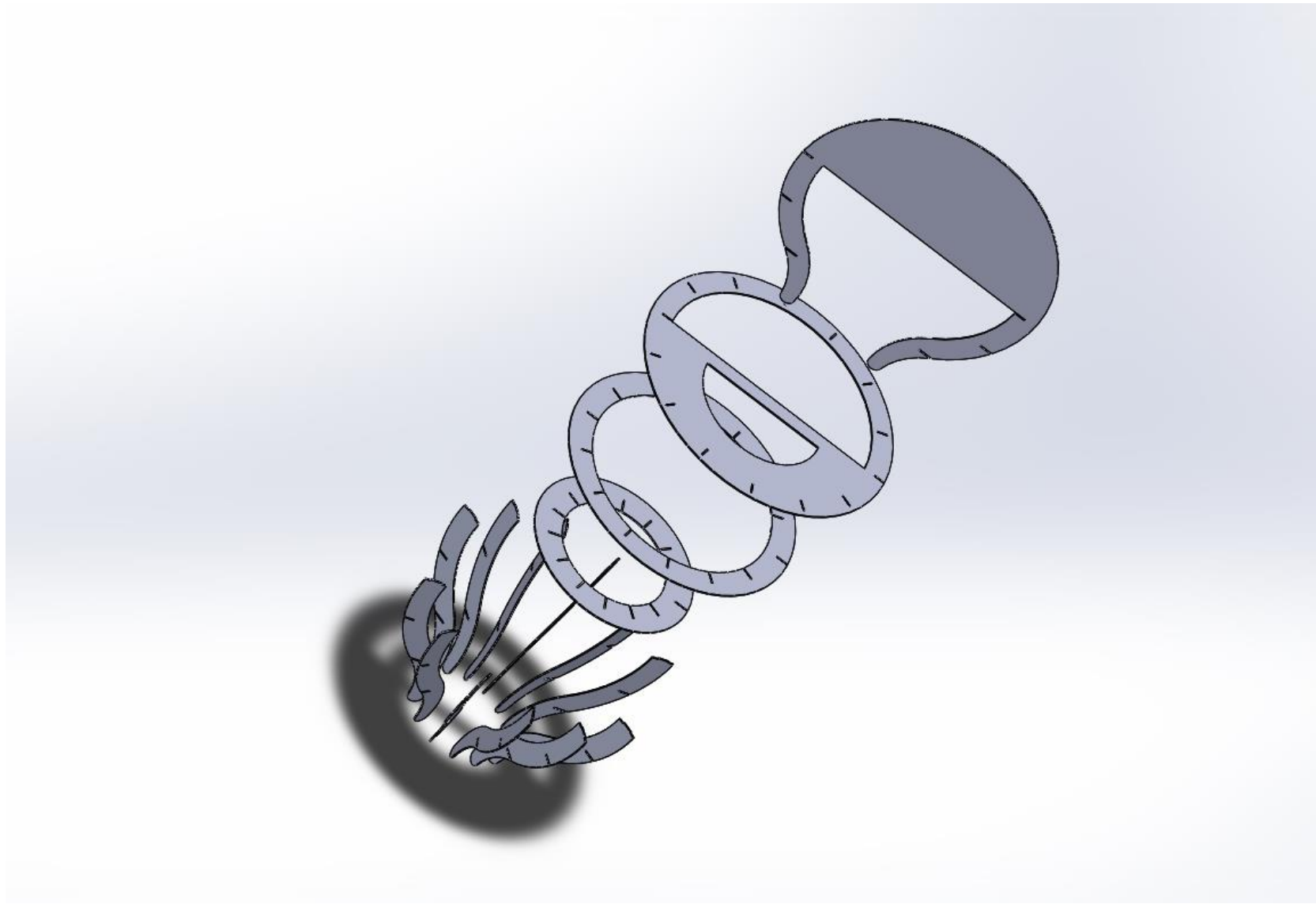

Projetos: Telebiosfera

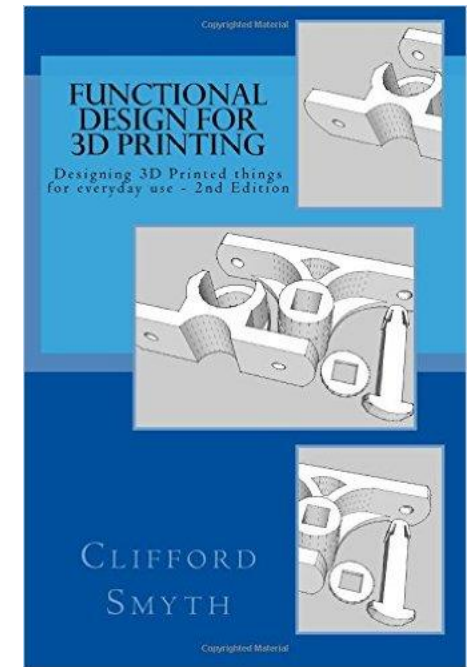
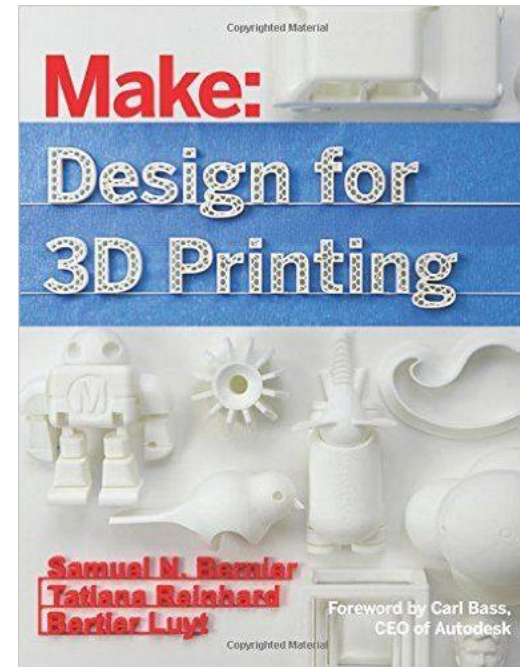
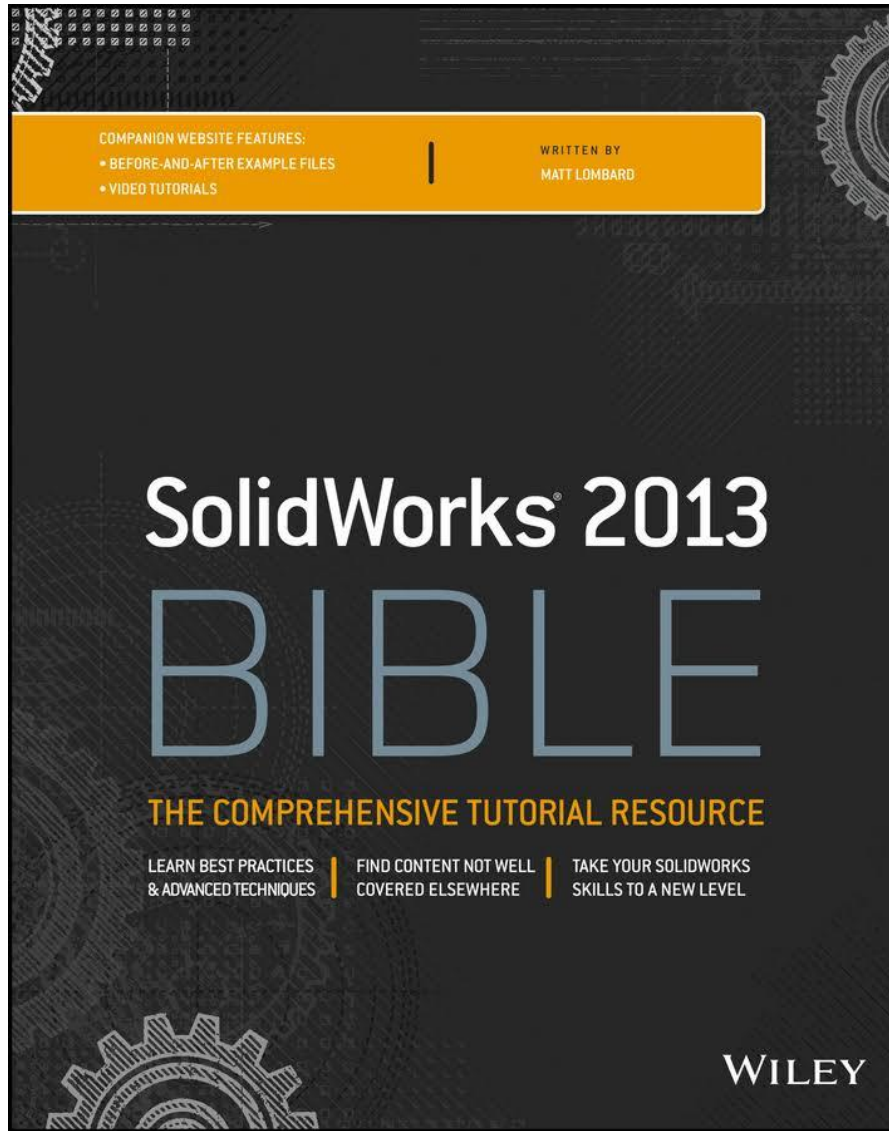

Referências